

# Sculptform Click-on Screens

Installation Guide



Scan to view our  
Installation Video

## IMPORTANT

This installation manual is intended to provide information that will enable designers, builders and owners to execute their projects effectively. Not all project types, design requirements and installation scenarios will be covered. The Sculptform team are happy to assist with project-specific solutions by contacting us on 1800 008 828 or emailing [support@sculptform.com](mailto:support@sculptform.com).

Product recommendations throughout the manual are generalised as guidelines on how the system functions, and intended for a technically competent person only. **As project specific requirements are different project to project, prior to installation, all engineering verification checks should be done on the final design at the shop drawing stage by the person or company contracted to design.** As Sculptform is typically supply only in terms of contract, Sculptform takes no responsibility in terms of "fit for purpose". It is important for designers, builders and owners to fully understand the product properties and capabilities, before making final selections. Please refer to our **Product Technical Datasheet** for more information.

It is the responsibility of designers, builders and owners to ensure that the information in this manual is current, by checking with Sculptform or referring to our website [sculptform.com](http://sculptform.com). As new technology is introduced or industry standards are altered, Sculptform reserves the right to alter existing specifications and delete product without notice.

The use of this manual does not:

- › guarantee acceptance or accreditation of a design, material or building solution by any entity authorised to do so under law;
- › mean that a design, material or building solution complies with the National Construction Code; or
- › absolve the user from complying with any local, State, Territory or Government legal requirements.

## Taking delivery

After being tallied and quality checked, each order is carefully packed, strapped and shrink wrapped. Our logistics department then arrange transport directly to your job site.

The following steps should be taken when accepting delivery:

1. Check against the consignment note that you have the correct quantity of packs.
2. Assess the overall condition of the packs. If there is any damage it should be recorded on the delivery document which is returned to the driver and the supplier must be notified immediately.
3. Find the packing slip which will be in a plastic sleeve on one of the packs. Check that every item is there and that the quantity is correct.
4. Do a quality check.
5. Notify Sculptform within 7 days of delivery if any items are out of specification.

## Onsite storage

Sculptform kiln dry timber to the midpoint of the average moisture content annual cycle in Australia. For this reason it is normally unnecessary to acclimatise the timber prior to installation. A general rule of thumb is to install the timber as soon as possible after machining so that it maintains its accuracy and straightness.

- › If possible the timber or aluminium should be kept in its original pack until installation. If it is repacked, it should be done the same as the original pack to maintain quality.
- › Timber should be stored at least 50mm above ground and stored on a flat surface to prevent bowing.
- › Store in a cool dry place out of the weather until ready to install with crates/packs tarped if being stored outside.

# Contents

<b>Mounting Options .....</b>	<b>4</b>
<b>The Components .....</b>	<b>5</b>
Mounting track types .....	5
Clip types .....	6
<b>Install Procedure - Back Mount (Balustrades).....</b>	<b>7</b>
Installing the mounting tracks .....	7
Preparing the battens .....	9
Installing the battens .....	10
<b>Install Procedure - End Mount (Free Standing Screens).....</b>	<b>12</b>
Installing the mounting tracks .....	12
Installing buttons and end caps.....	15
Installing the battens .....	10
<b>Installing Curved Tracks .....</b>	<b>18</b>
<b>Installing the Threaded Rod and Spacers .....</b>	<b>18</b>
<b>Removing a Batten.....</b>	<b>19</b>

# Configuration Options

FIXED

FLOATING

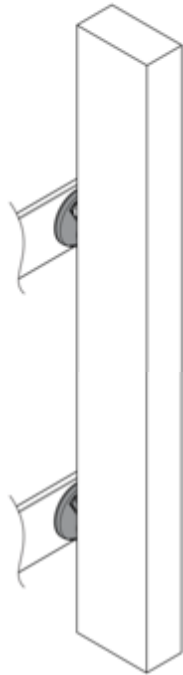

**Back Mounted Configuration**

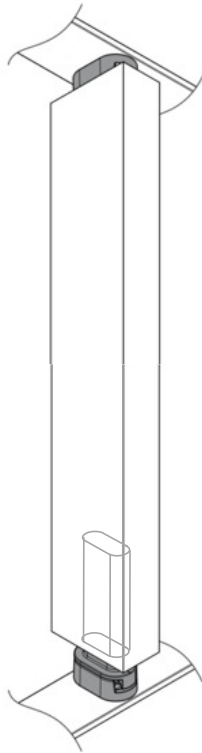

**End Mounted Configuration**

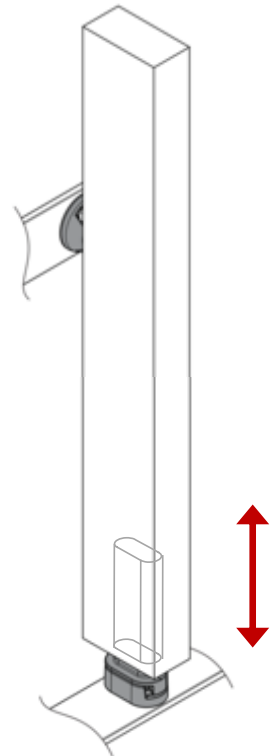

**Combination Back/End**

# The Components

## Mounting track types

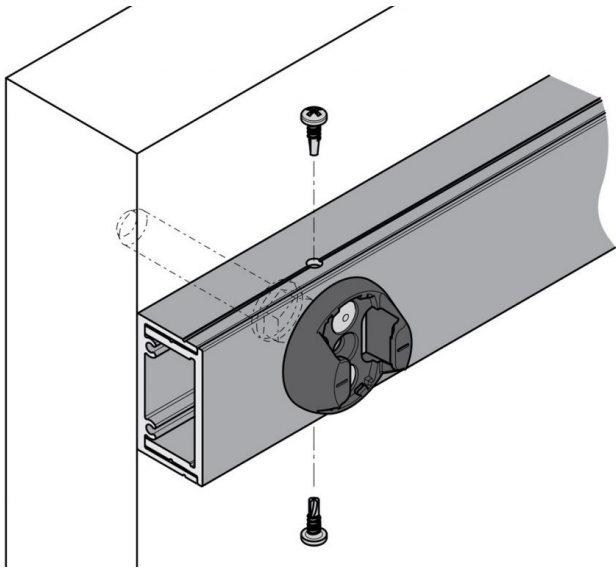

### Split track - 45mm wide x 25mm deep

Used in straight applications for both back mount and end mount. Track has pull out adjustment from 25-35mm, to allow onsite packing.

---

**Note:** Kerfing split track greatly reduces the capacity of the track and may not be suitable for your application. See page 18 for more information.

---

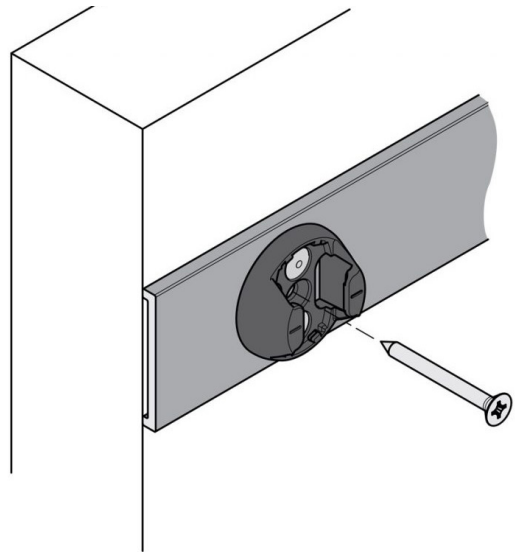

### Slim Track - 45mm wide x 5mm deep

Default end mount track, designed to be slim to the floor and ceiling. Used for back mount curves down to a 600mm Radius. Fixing of this track must be through the centre of the clip casting.

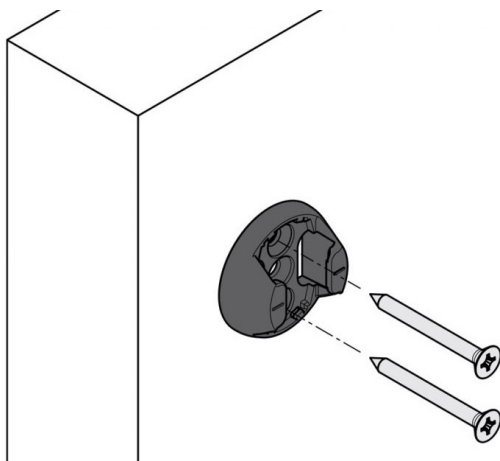

### Direct Fix

Where no track is desired for both back mount and end mount. Complex site specific spacing. Sculptform does not take responsibility for the clip to substrate connection. Screw not supplied by Sculptform. Suitable fixing needs to be considered by the installer. M5 or 10g countersunk screw is most suitable.

# The Components

## Connection types

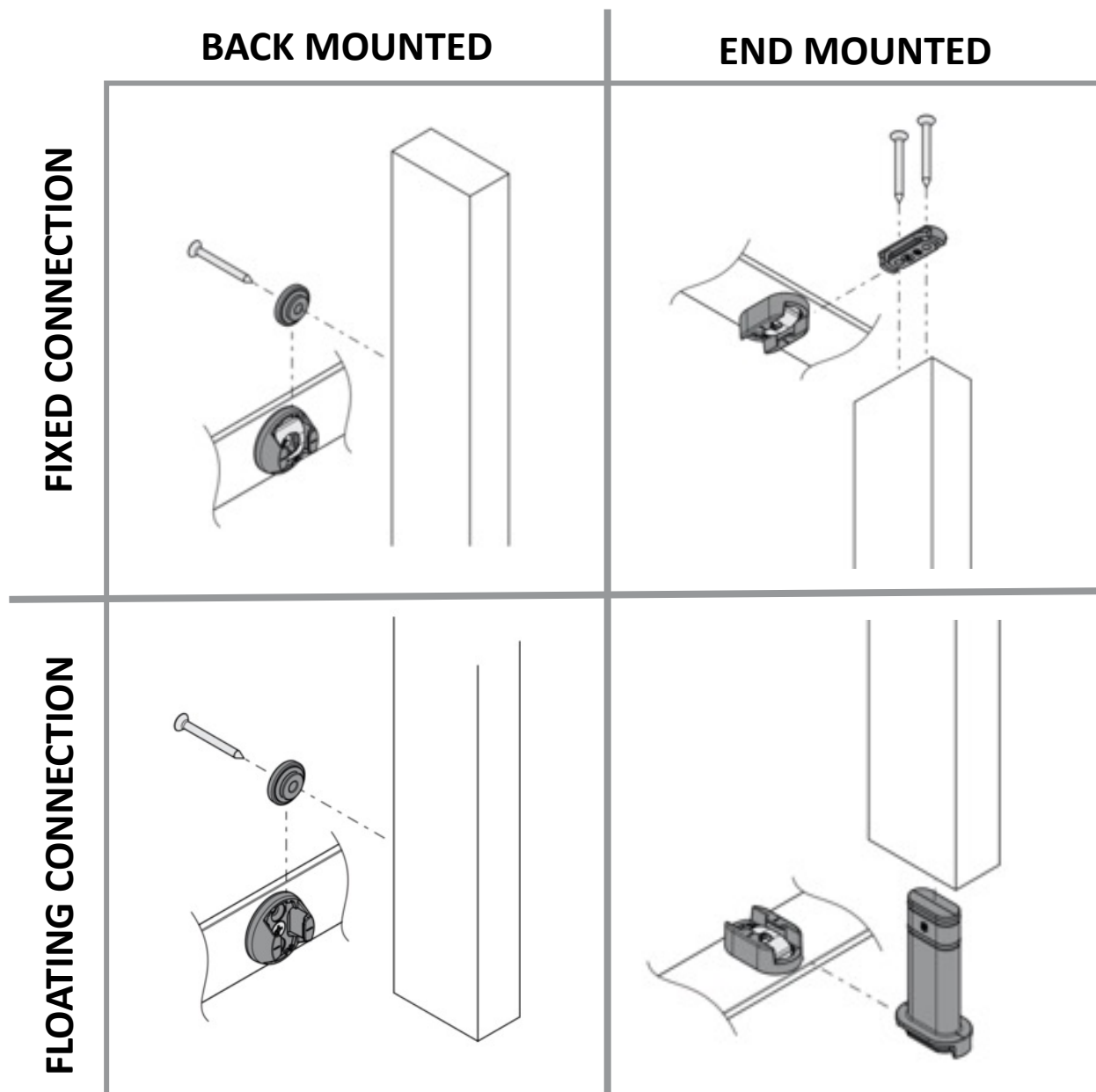

# Installation Procedure - Back Mount (Balustrades)

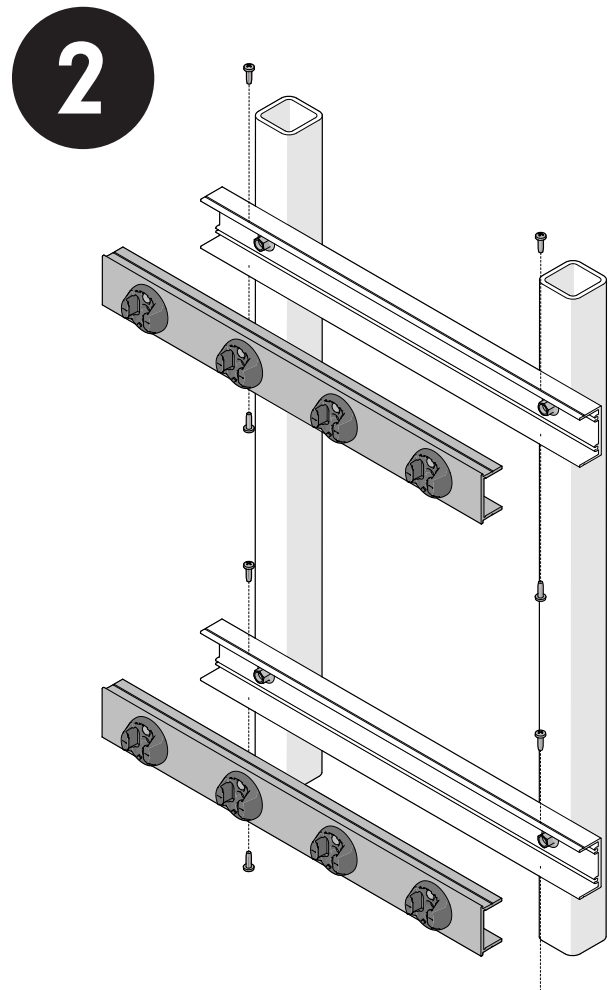
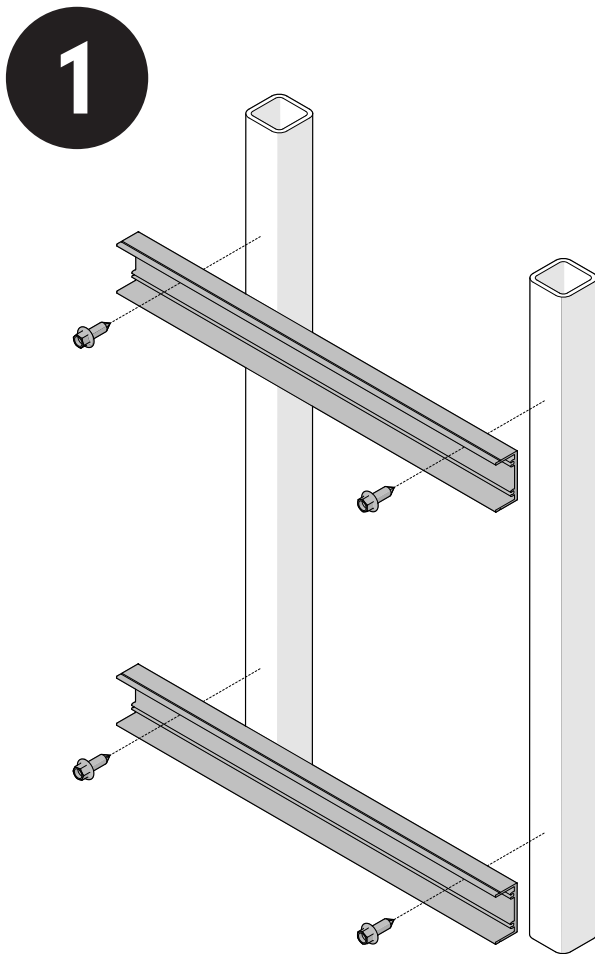

## Installing the Mounting Tracks

Install the Mounting Track Base (Part 2) to the substrate at the specified centres, using suitable fixings (these are not supplied by Sculptform).

---

**Note:** the top rail will become the reference line for the top of the battens, so it is important special attention is given to its position. This is the same principle as installing split batten systems.

---

---

**Note:** when installing the tracks. Ensure they are spaced within an up/down tolerance of  $\pm 2\text{mm}$ .

---

Fit the mounting track with pre-fitted clips (Part 1) into the Base profile ensuring the Clips line up vertically. To fix the mounting track, use the black self-drilling screw supplied to stitch the two parts together.

---

**Note:** The split track allows for up to 10mm of onsite adjustment where the substrate is not plumb.

---



# Installation Procedure Continued

3

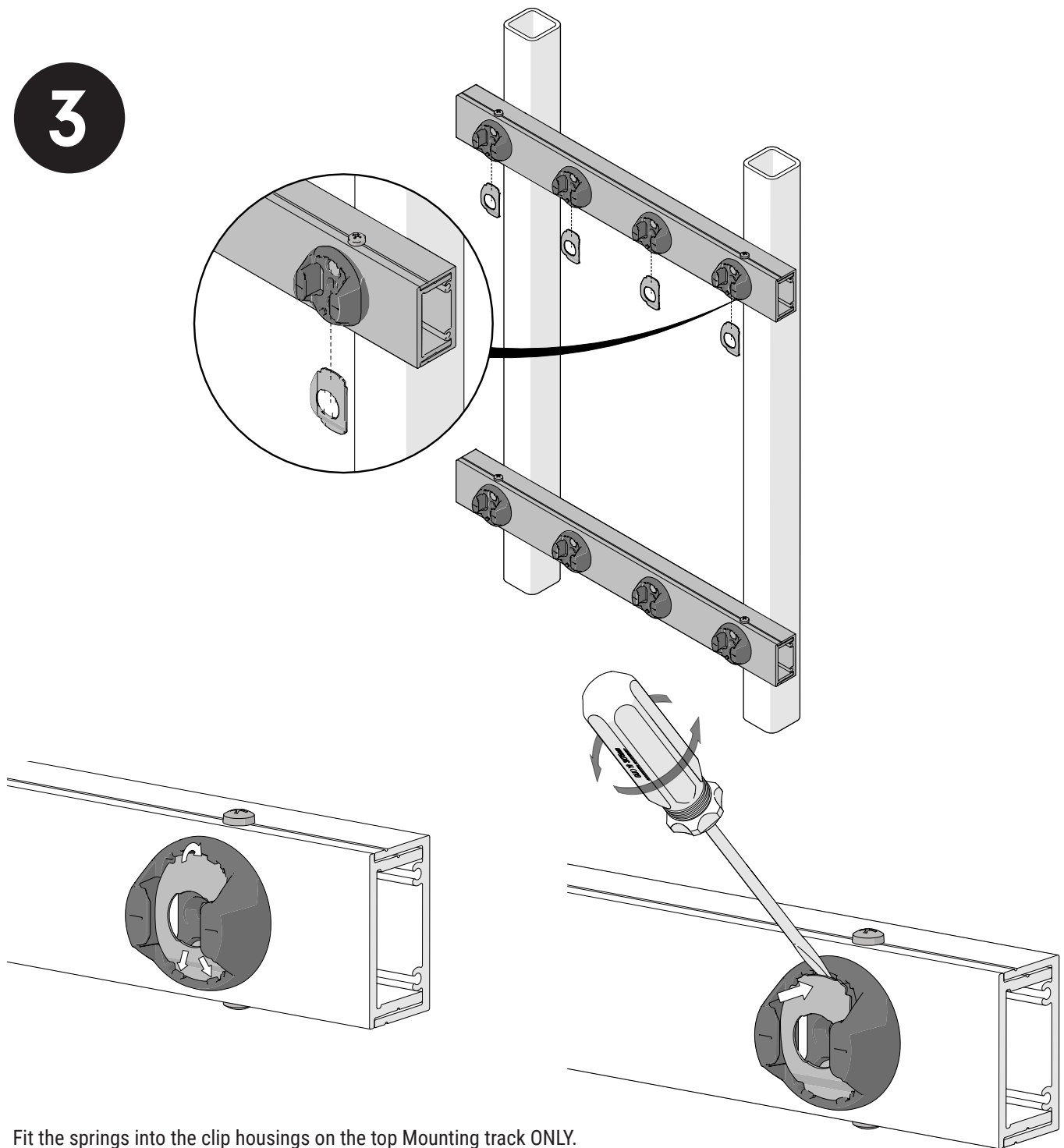

Fit the springs into the clip housings on the top Mounting track ONLY. To do this, slide the spring into the clip housing and engage under the small tabs on one side. Place small flat head screwdriver head between the spring and the outer wall of the housing, and rotate screwdriver. The spring should just clear the tabs. Gently press down into place.

---

**Note:** This spring will allow the buttons to snap in. It is important to only install these springs into one of the tracks to allow the other button to 'float' in the clip base to accommodate inconsistencies and ongoing movement.

---



# Installation Procedure Continued

4

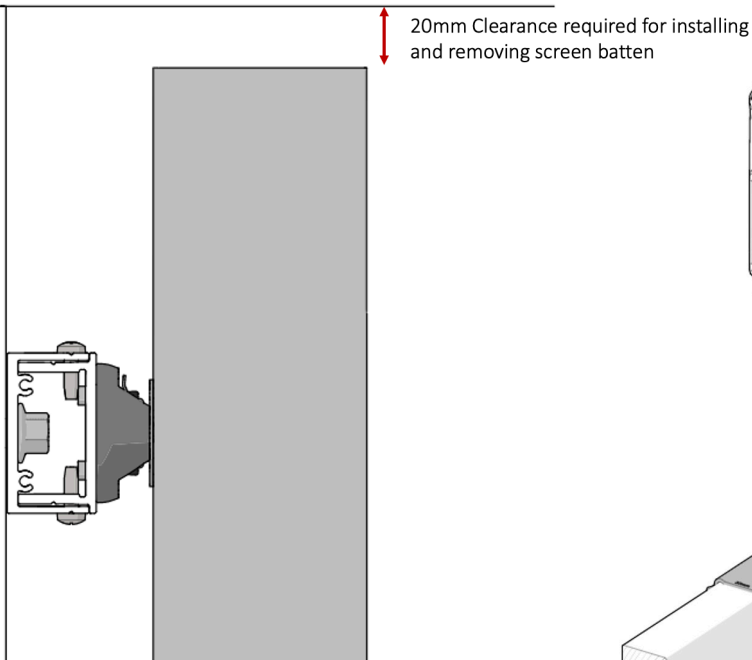

5

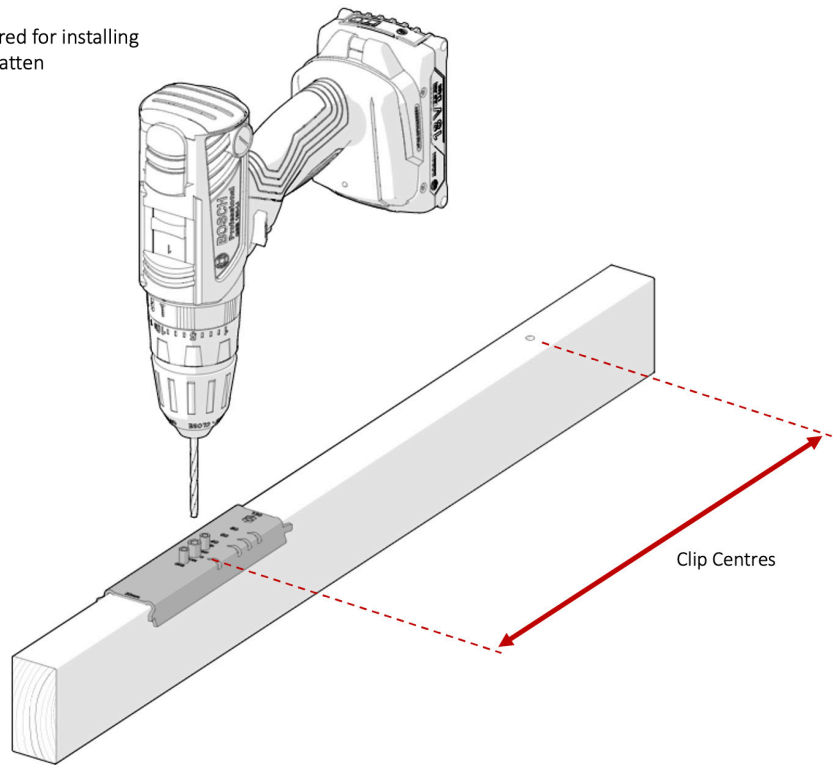

## Preparing the Battens

If required, trim the screen battens to length.

---

**Note:** For installing and removing screen battens, 20mm clearance above or below them is required.

---

Mark out and pre-drill holes for the buttons in the back of the screen batten with a 4mm drill bit and the single central hole on the pilot hole jig. The buttons should be mounted central to each of the clip bases.

---

**Note:** Either mark out use the centre reference slot on the jig to locate the button position or set up your own jig to reference off the end of the batten.

---

---

**Note:** when using the Pilot hole jig only drill 2-5mm to mark the position before taking the jig off and completing the hole. This will reduce the jig rounding and wearing out.

---

# Installation Procedure Continued

6

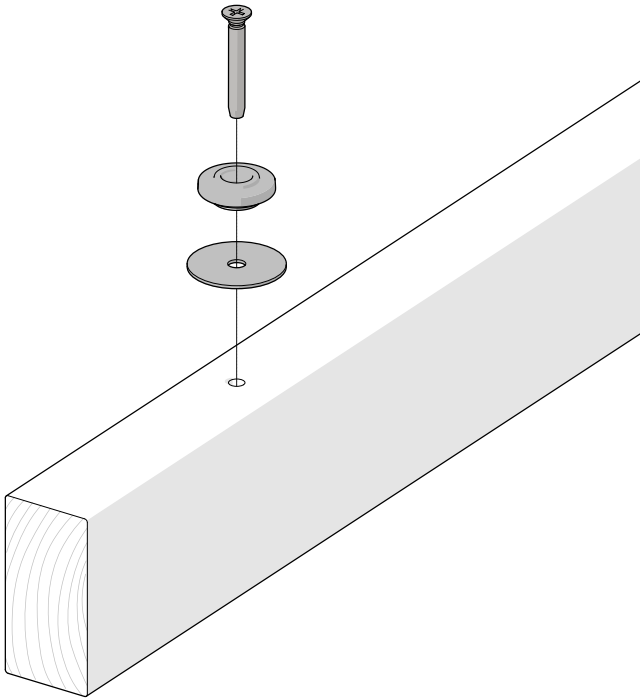

Screw the buttons onto the battens using a 10g countersunk screw. For timber battens, a washer is required between the button and the batten. For aluminium battens, this washer is not required.

7

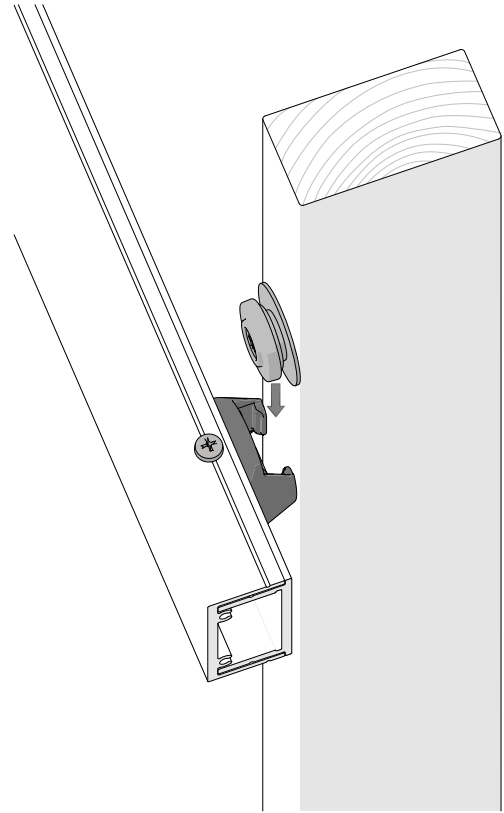

## Installing the Battens

Locate the screen batten so that the fitted buttons are just above the clips on the mounting track. Ensure all buttons are aligned to the clips.

# Installation Procedure Continued

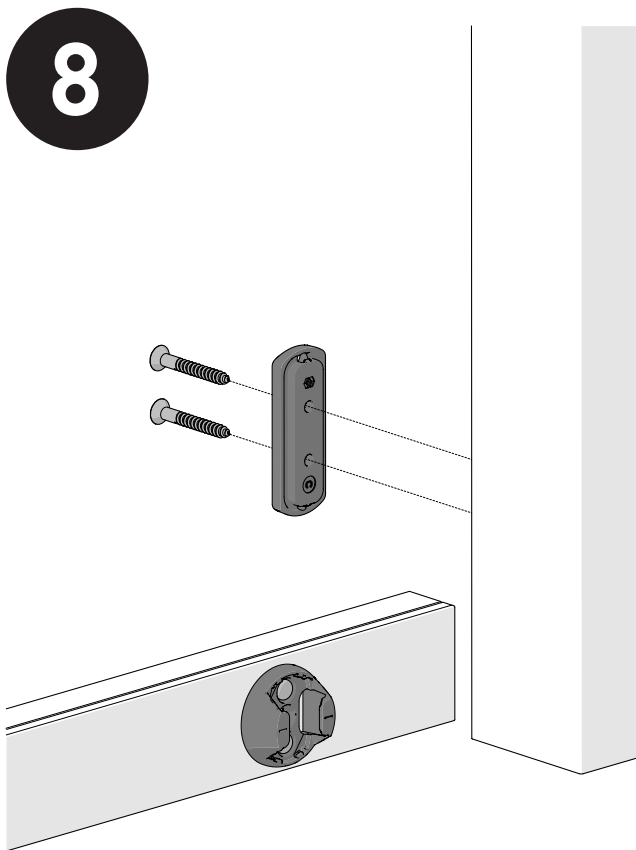

---

**Note:** Used for external applications or instances involving extensive spans with significant thermal fluctuations.

---

Contact [support@sculptform.com](mailto:support@sculptform.com) for more information.

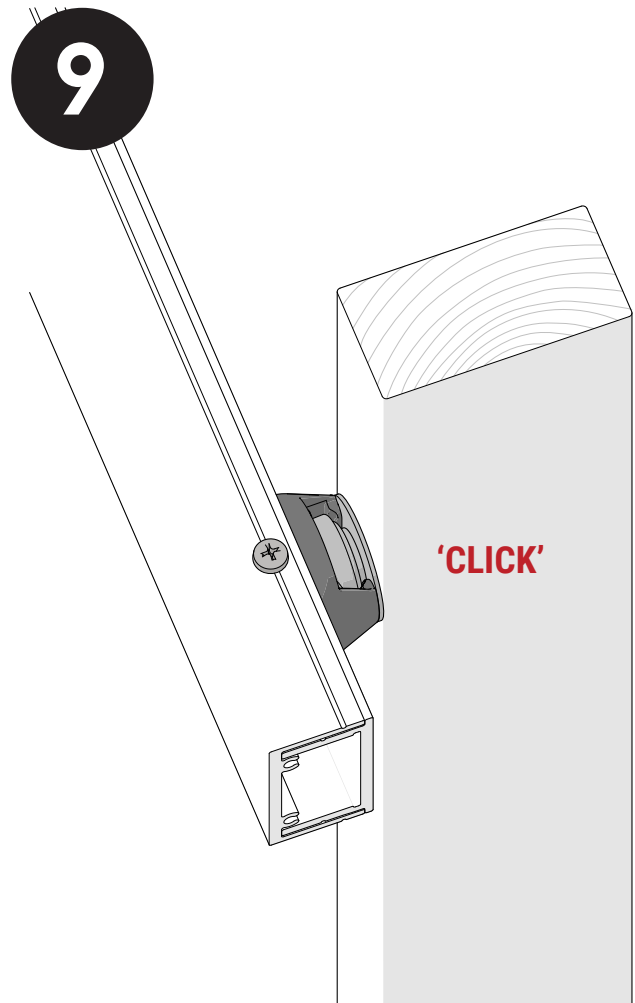

Pull the screen batten down. The buttons will slide into the Clip base, and you will hear the spring 'click', locking the button into position. To double check the engagement, try to lift the batten back up to ensure it has engaged.

---

**Note:** If there is not enough clearance at the top of the battens, you can engage the clip by pushing it up into the clip too.

---

Continue this process.

# Installation Procedure - End Mount (Free Standing Screen)

1

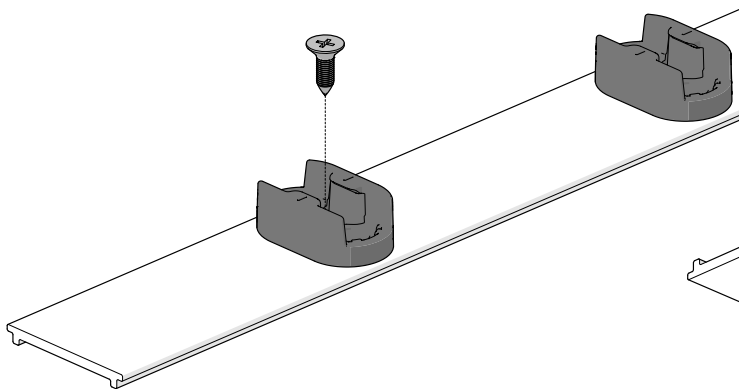

2

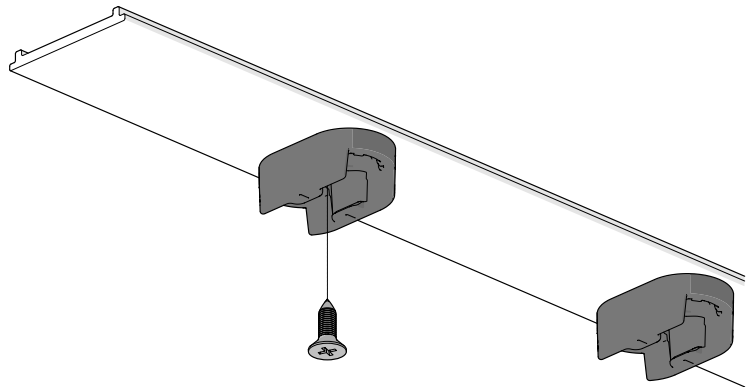

## Installing the Mounting Tracks

Install the Mounting Track to the floor using suitable fixings. It is recommended to use 10g countersunk head anchor screw to ensure the head of the fixing does not clash with the spring inside the clip.

Install the corresponding top track on the ceiling, ensuring the clips line up vertically.

---

**Note:** Fixing centres to be between 300-400mm.

---

# Installation Procedure Continued

3

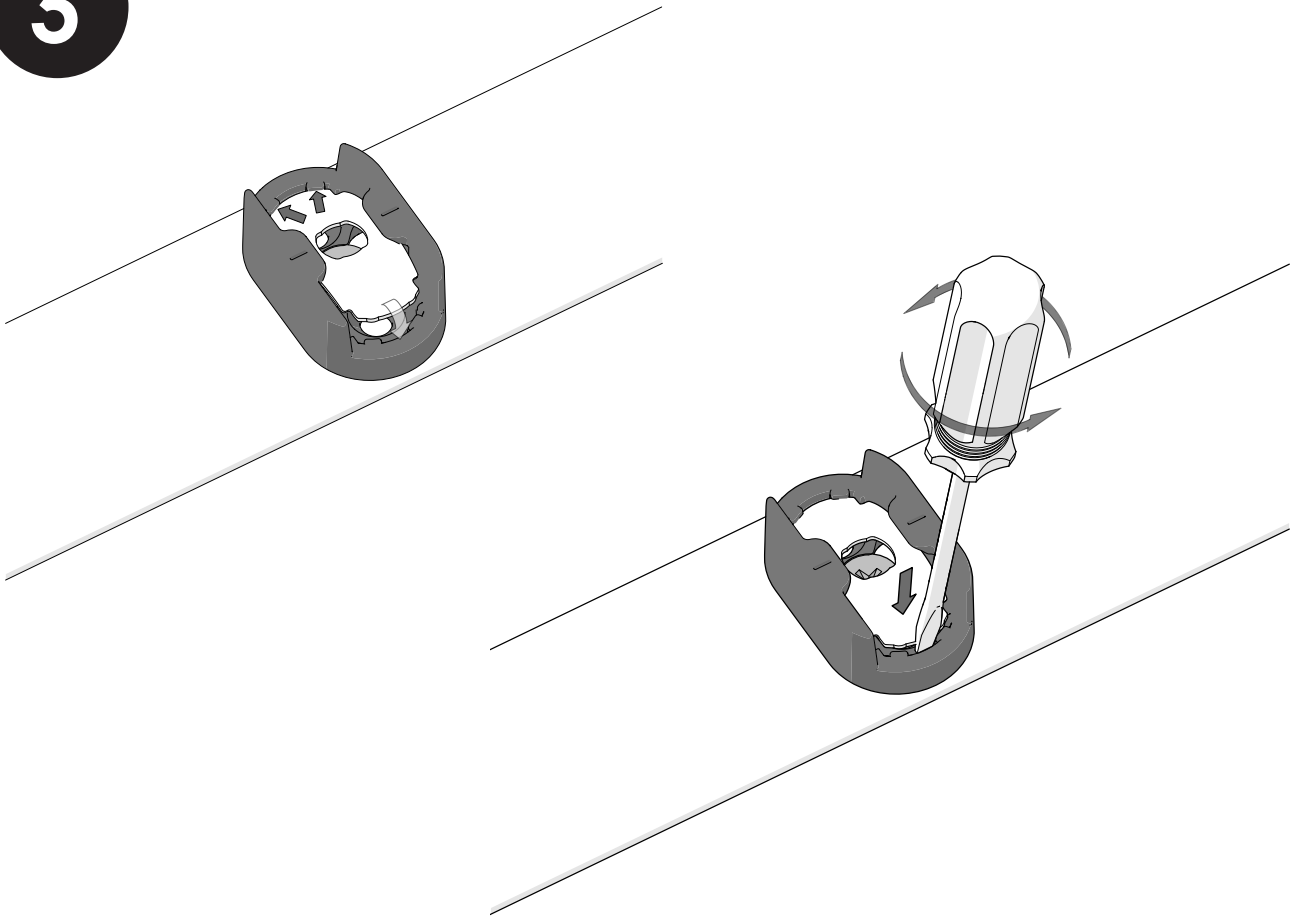

Fit the stainless-steel springs into the housings on both tracks. To do this, slide the spring into the clip housing and engage under the small tabs on one side. Place a small flat head screwdriver head between the spring and the outer wall of the housing and rotate screwdriver. The spring should just clear the tabs. Gently press down into place.

# Installation Procedure Continued

4

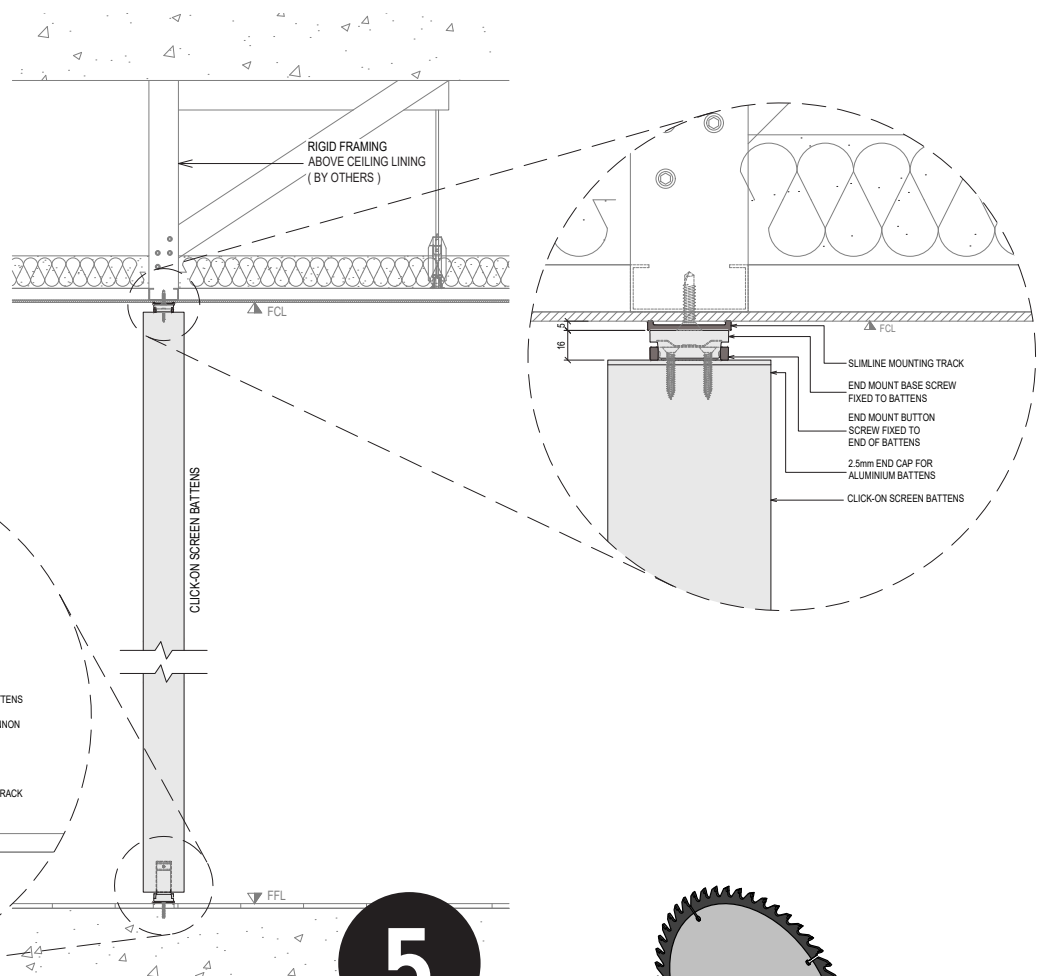

5

Measure the distance between the top and bottom rail to work out the finished length of the batten required, referring to the clip dimension details below.

**Note:** consider expected slab deflection in your application. For an interior free standing screen aim for about a 5mm clearance gap. If installing on the edge of a cantilevering external balcony a 25mm clearance gap is expected.

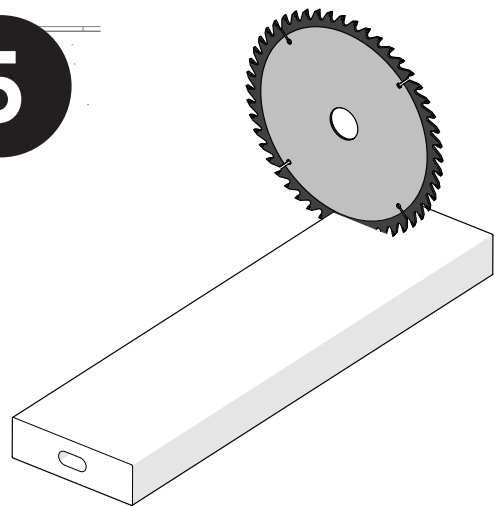

Trim the battens to length. The screen battens will be delivered slightly over length for final trimming onsite.

**Note:** for timber battens there will be a mortice slot on one end and a straight cut on the other. Be sure to only trim the blank end.

# Installation Procedure Continued

6

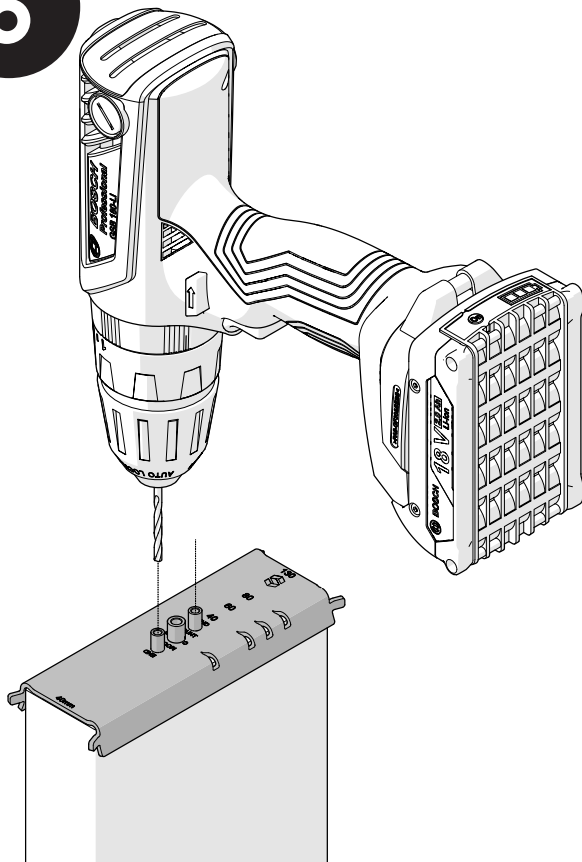

## Installing Buttons and End Caps

### Timber

If installing timber battens, drill the 2x3mm pilot holes in the top of the batten for the End Mount button using the two side holes on the jig. To centralise the holes, align the relevant reference slot with the edge of the batten.

---

**Note:** when using the Pilot hole jig only drill 2-5mm to mark the position before taking the jig off and completing the hole. This will reduce the jig rounding and wearing out.

---

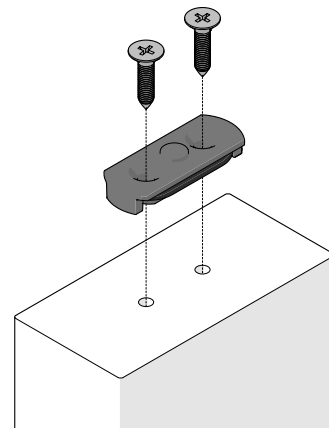

### Aluminium

If installing aluminium battens, screw the end caps in after trimming them to length. The mortice end cap is installed on the base and the button end cap on the top.

---

**Note:** If installing aluminium battens, both ends should be cut a minimum of 50mm to ensure that the final length is blemish free.

---

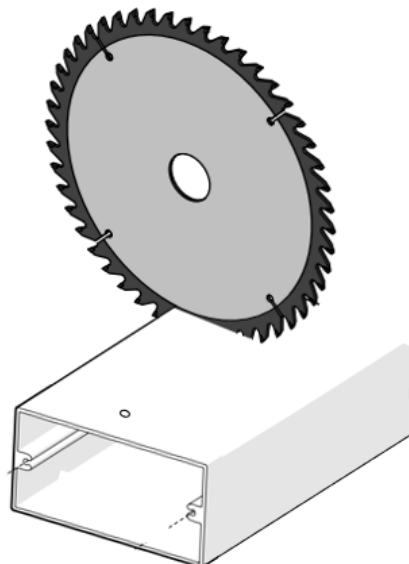
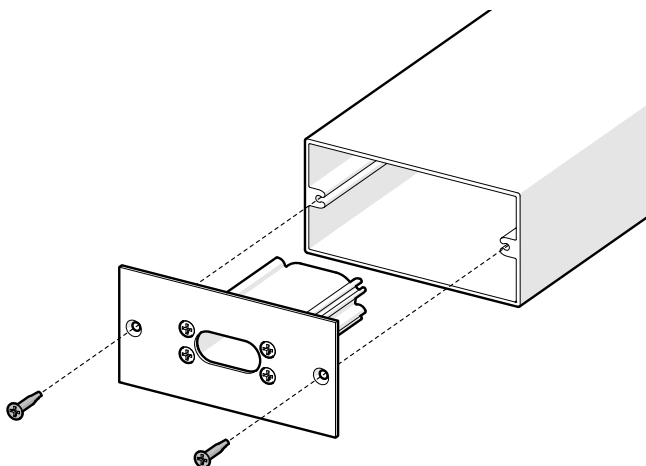



# Installation Procedure Continued

7

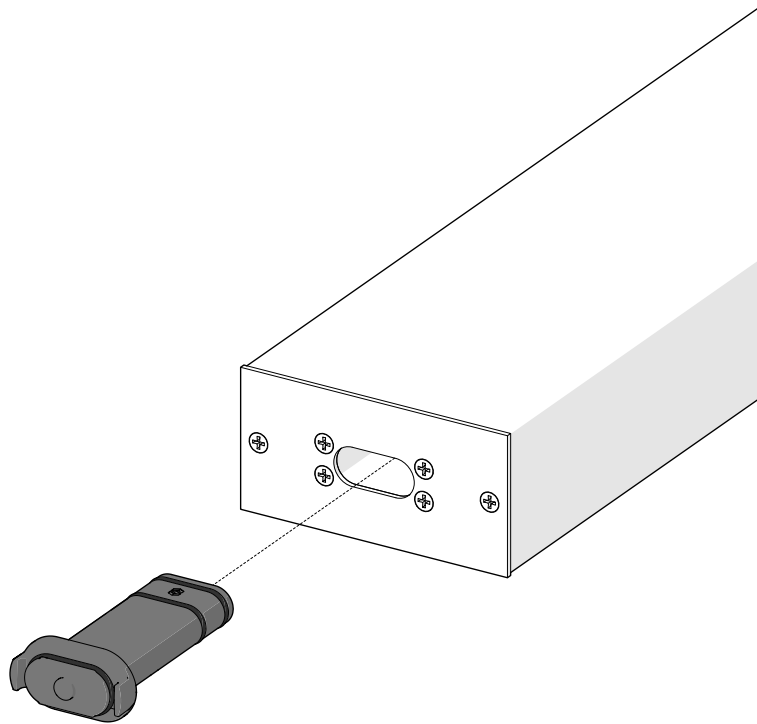

Slide the tenon component into the mortice in the batten.

# Installation Procedure Continued

8

Hook the top button into the clip base on the top track. Slide to align the height of the tenon at the base and push to engage both top and bottom clips. The spring inside the clip base will lock the button and tenon into position with a 'click'. To double check the engagement, tug on the batten to test its security.

Continue installing battens, regularly checking the clearance gap and adjusting the lengths to suit.

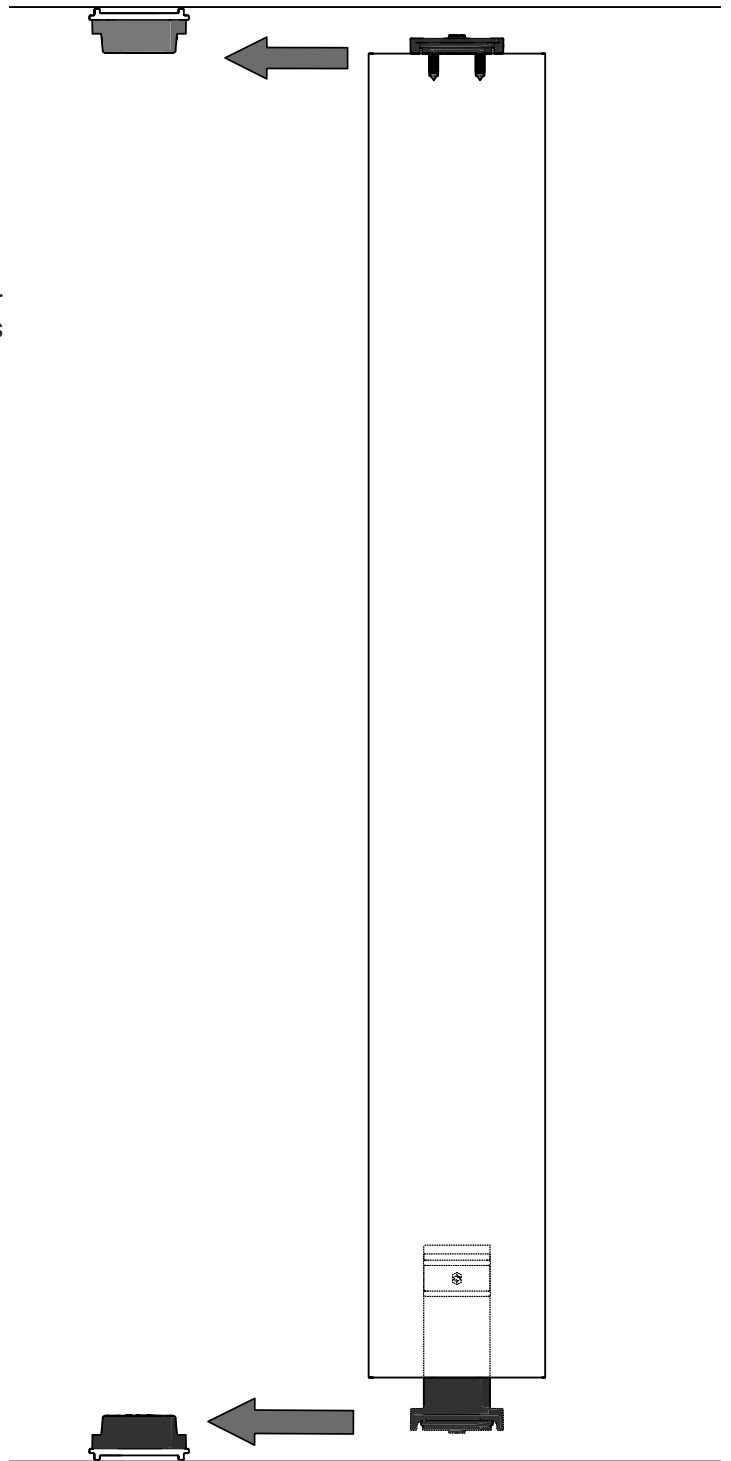

# Installing Curved Tracks

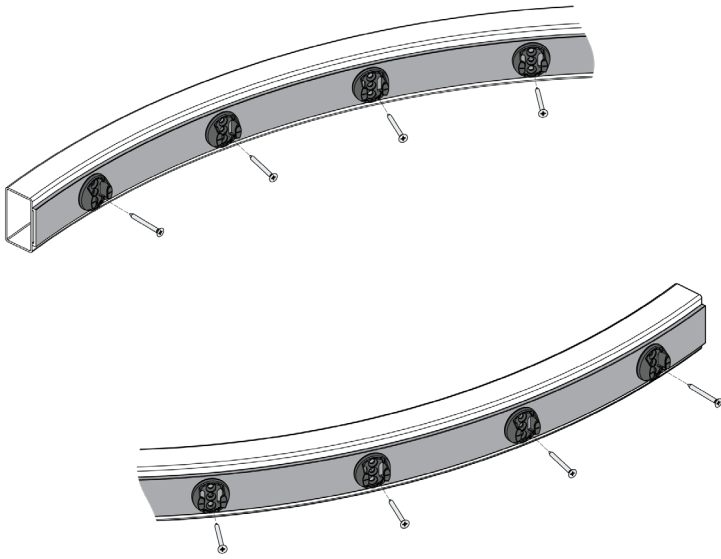

## Back Mounted

If the screen is back mounted onto a curved surface, the slim track may be used. The slim track is flexible enough to accommodate up to a 600mm radius.

**Note:** the top rail will become the reference line for the top of the battens, so it is important special attention is given to its position. As the track has lower stiffness in the back mounted application, each mount should be screwed fix through the centre of the mount with a 10g countersunk screw.

**Note:** that the engineer assigned to the project should ensure the suitability of the substrate supporting the slim track along with its thickness to ensure that the screw fixing to substrate is suitable to resist the design loads of the project.

# Installing the Threaded Rod and Spacers

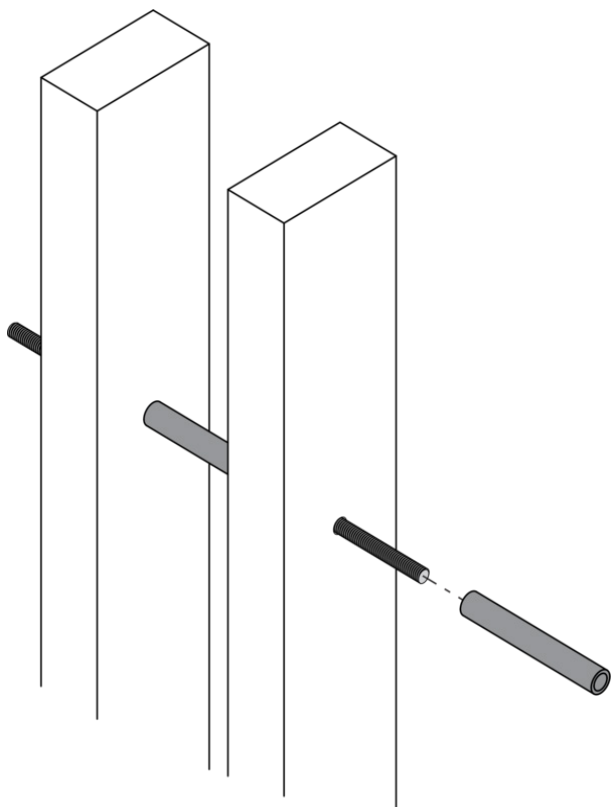

If the screen requires threaded rod and spacers as a centre support, the screen battens will be delivered with the holes pre-drilled.

1. Cut the threaded rod to length
2. Thread the rod through the hole in the first batten and into the spacer sleeve, then into the next batten and continue.
3. Fit the connector nut on both sides and tighten.

# Removing a Batten

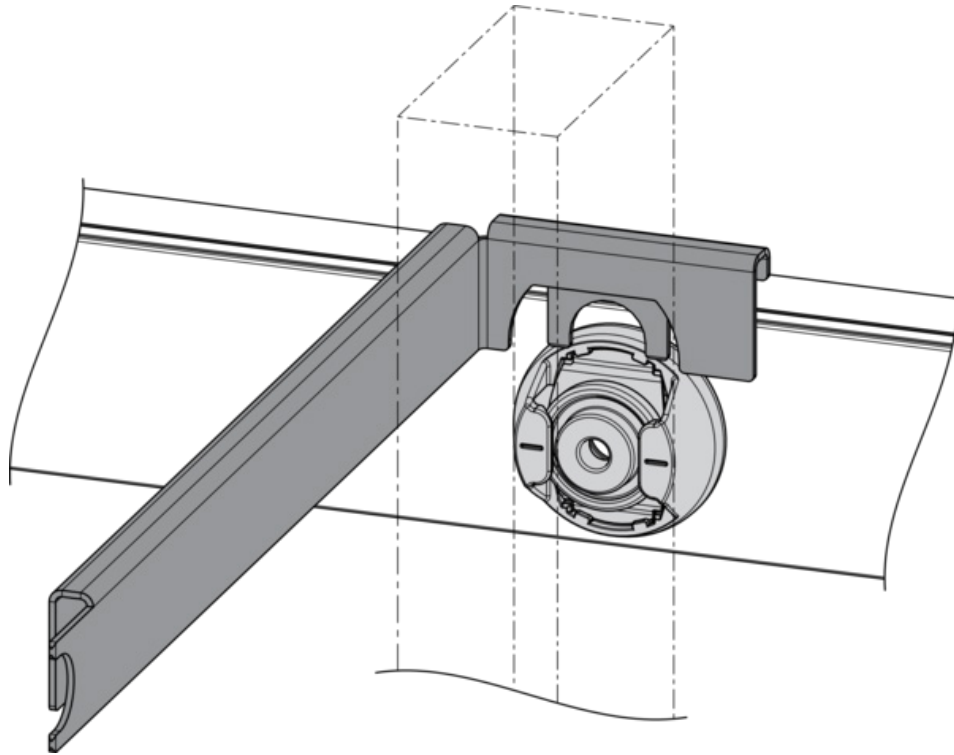

1. Slide the removal tool prongs under the button and push in until fully engaged. This will flatten the spring to allow the button out.
2. Lightly tap the batten until the button is half out.
3. Slide the removal tool out (to stop it from falling) and then tap the batten out completely.

---

**Note:** If you damage the spring in the clip while completing this process, it is critical the spring is replaced before re-installing the screen batten

---

